

Zone 2

Eligible voters reside “inside” boundary lines.

Example: Zone 2 eligible voters reside on the east side of State Hwy 91; Zone 2 eligible voters reside on the north side of Taylor Hwy; Zone 2 eligible voters reside on the east side of Park Avenue.

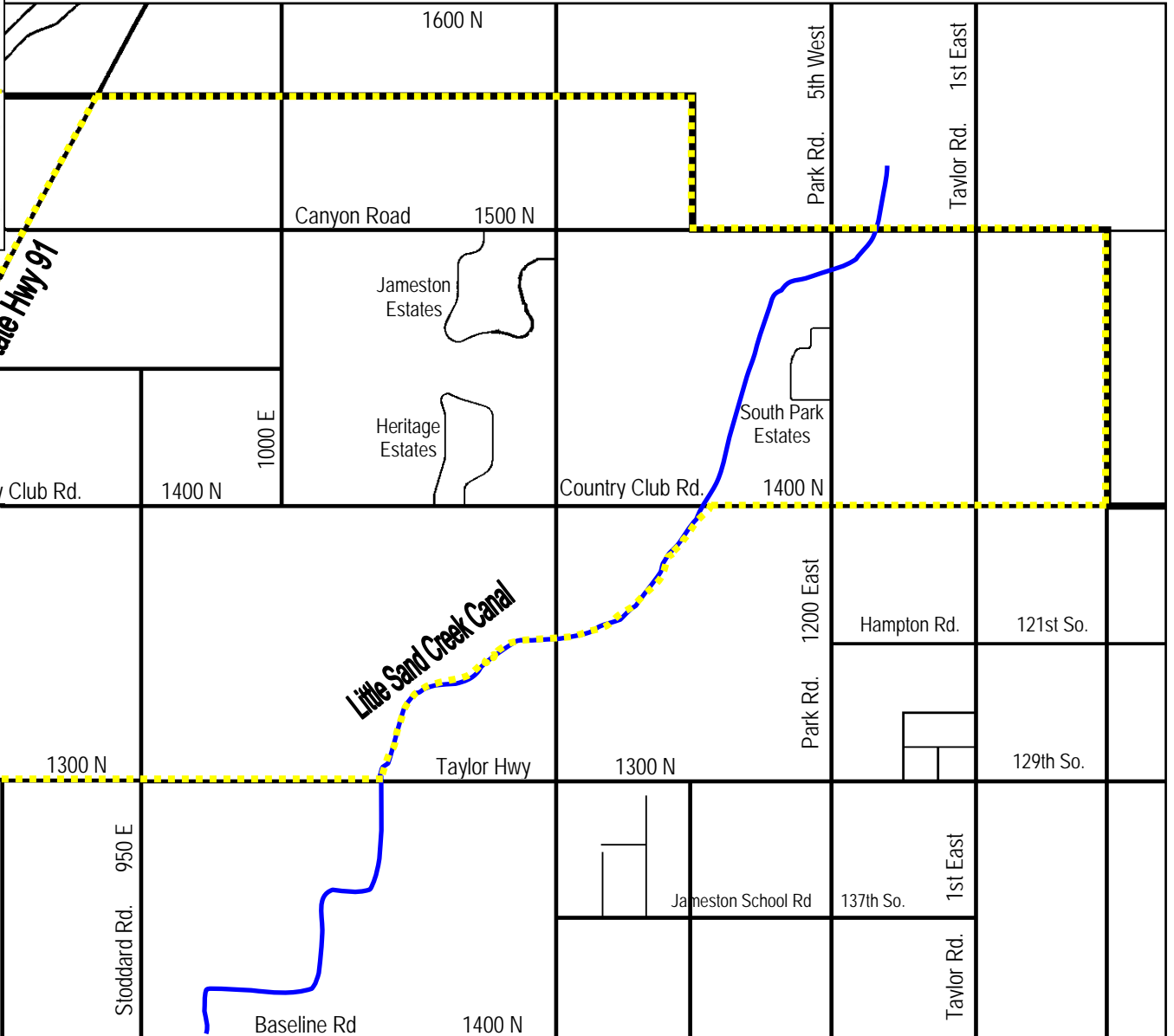
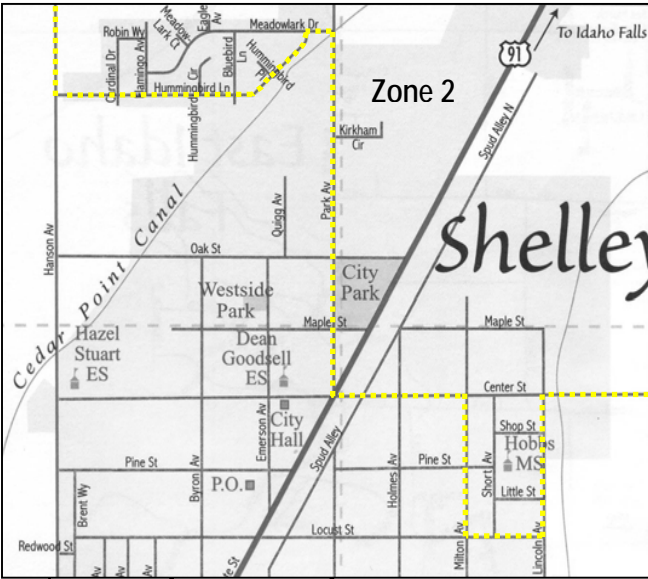

Zone 2 – Legal Description

Beginning at the intersection of 1400 North and U.S. Highway 91 and running thence Northeast to the intersection of U.S. Highway 91 and the east-west centerline of Section 15, Township 1 North, Range 37 East, B.M.; thence East to the center of Section 13; thence South ½ mile to 1500 North (Canyon Road); thence East 1 ½ miles to the NE corner of Section 19, Township 1 North, Range 38 East, B.M.; thence South 1 mile to 1400 North; thence West approximately 1 ½ miles to the intersection of 1400 North and the Little Sand Creek Canal; thence Southwesterly along said creek to its intersection with 1300 North (Taylor Road); thence West approximately 2 miles to the East boundary of the City of Shelley; thence along said east boundary to Lincoln Avenue; thence South to the intersection of Lincoln Avenue and Locust Street; thence West to the intersection of Locust St. and Milton Avenue; thence North to the intersection of Milton Avenue and Center Street; thence West to the intersection of Center Street and US Hwy 91; thence North to the intersection of Park Avenue and Meadowlark Drive; thence West to the intersection of Meadowlark Drive and Hummingbird Lane; thence South and West to the intersection of Hummingbird Lane and Hanson Avenue; thence North to the intersection of Hanson Avenue and 1400 North; thence East approximately 1 mile to the Point of Beginning.