

Zone 5

Eligible voters reside “inside” boundary lines.

Example: Zone 5 eligible voters reside on the east side of State St; Zone 5 eligible voters reside on the west side of Milton Ave; Zone 5 eligible voters reside on the south side of Center.

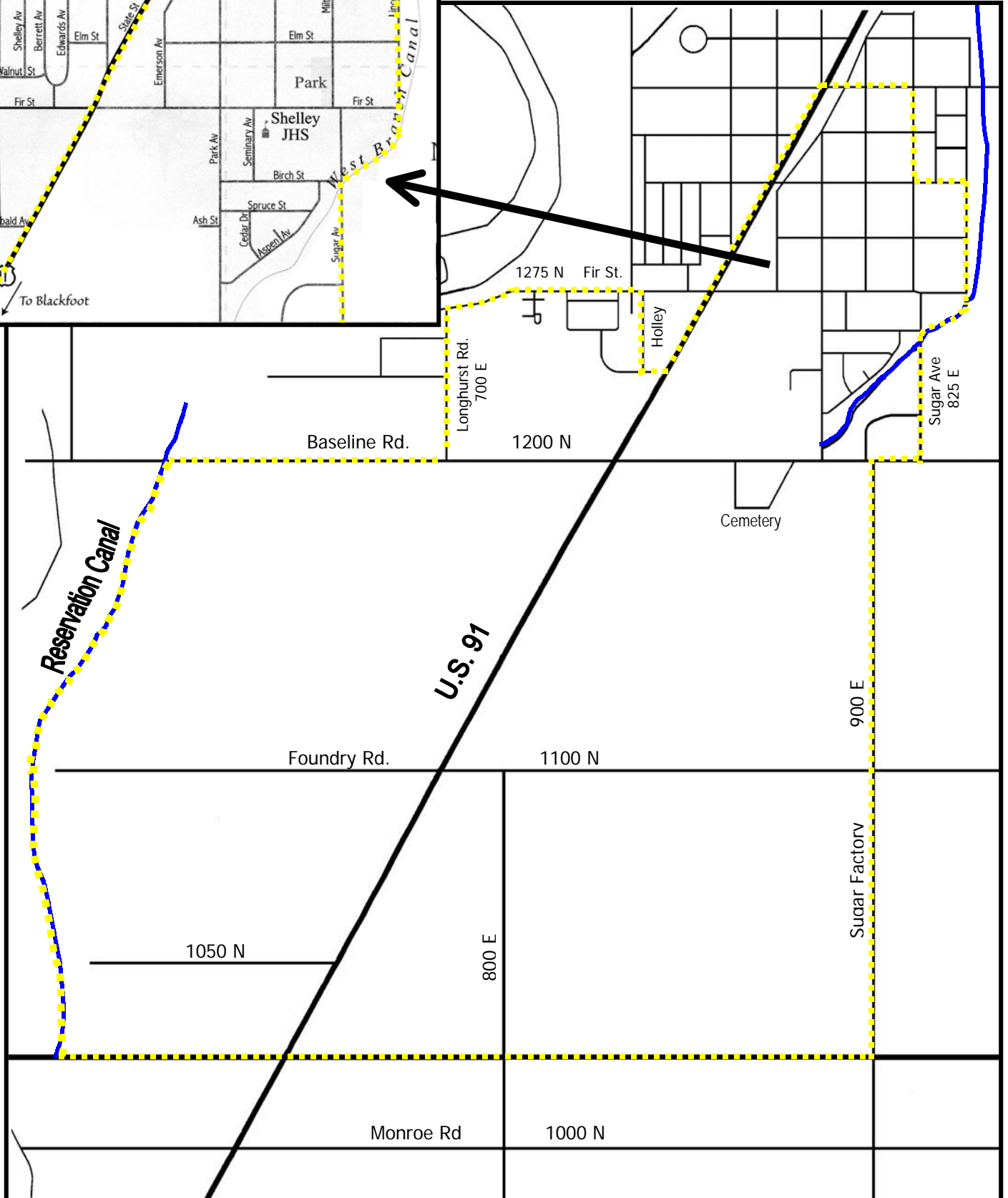
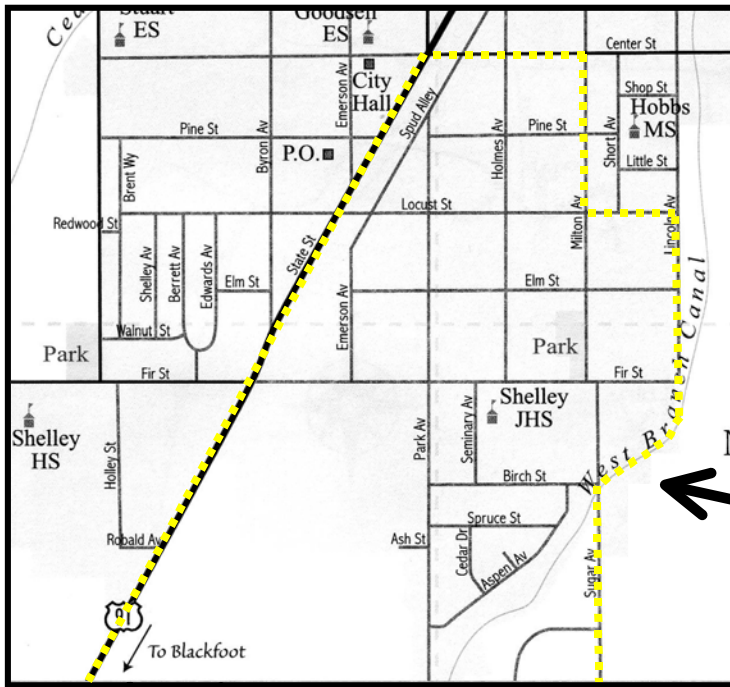

Zone 5 – Legal Description

Beginning at the intersection of U.S. Highway 91 and Taylor Road and running thence East to the intersection of Taylor Road and Milton Avenue; thence south to the intersection of Milton Avenue and locust street; thence East to the intersection of Locust Street and Lincoln Avenue; thence South to the intersection of Lincoln Avenue extended and West Branch Snake River Valley Canal; thence Southwesterly along said canal to its intersection with 825 East; thence South to the intersection of 825 East and 1200 North; thence West to the intersection of 1200 North and 900 East; thence South approximately $1\frac{3}{4}$ miles to a point on the South boundary of Shelley School District No. 60 that is approximately $\frac{1}{4}$ mile North of the South line of Section 9, Township 1 South, Range 37 East, B.M.; thence West to the Reservation Canal; thence Northerly along said canal to its intersection with 1200 North; thence East approximately $\frac{3}{4}$ mile to the intersection of 1200 North and 700 East; thence North approximately $\frac{1}{2}$ mile to the intersection of 700 East and 1275 North; thence East approximately $\frac{1}{2}$ mile to the intersection of 1275 North (Fir Street) and Holley Street; thence South to the intersection of Holley Street and Robald Street; thence East to the intersection of Robald Street and U.S. Highway 91; thence Northeasterly along U.S. Highway 91 to the Point of Beginning.